

# HEIGHT RIGHT™ chair

Revision 0313  
UMHR03-13LIT

AGES 3 YEARS AND UP

2 EN

**CHAIR ASSEMBLY**  
ages 3 years and up

5 EN

**CONVERSION TO**  
**CHAIR + Early Pelvic**  
**Positioner+ TRAY**  
under 3 years of age

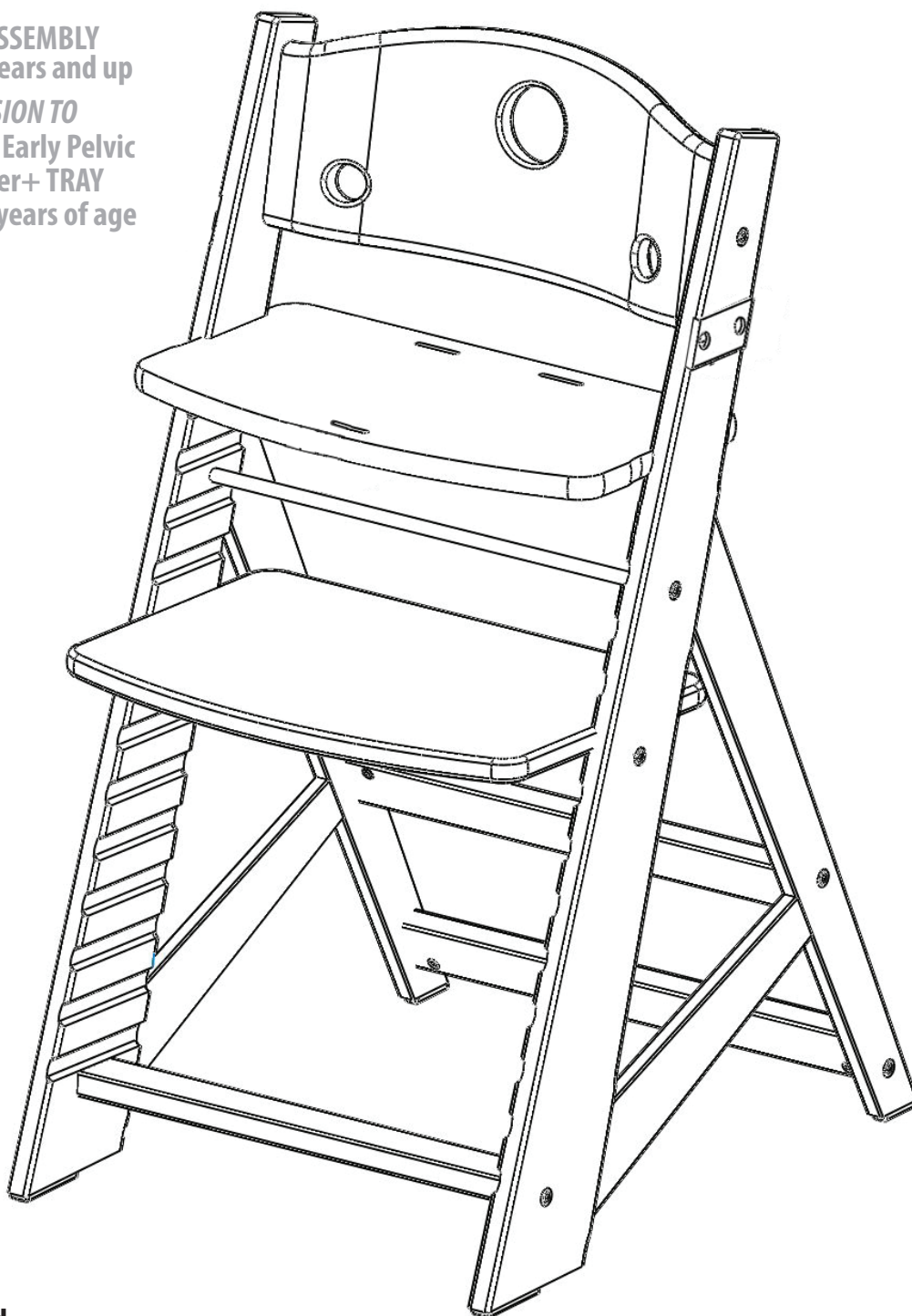

## **AUTHORISED EUROPEAN REPRESENTATIVE**

GLOBAL CAREHAB  
ROSENVANGS ALLE 32  
8260 VIBY J  
DENMARK  
+45 24 65 55 50



© Bergeron Companies [www.specialtomato.com](http://www.specialtomato.com)

# Height Right™ Chair

**⚠️WARNING:** The Height Right Chair is a youth chair and is designed for use by children 3 years of age and up.

**⚠️WARNING:** Prevent serious injury or death from falls or sliding out.

**⚠️WARNING:** The Height Right Chair can be converted to a High Chair with the use of the Early Pelvic Positioner in conjunction with the Tray. The Early Pelvic Positioner is ALWAYS required when using the Tray for children under 3 years of age. (Early Pelvic Positioner and Tray can be Purchased Separately)

## ⚠️WARNING:

- Always secure child in the restraint
- Never leave child unattended
- Always keep child in view
- Secure straps tightly
- Never use as a stepping stool
- The front edge of the footrest should never extend beyond the bottom edge of the front supports at floor level
- Always use chair on a smooth level surface

## Parts

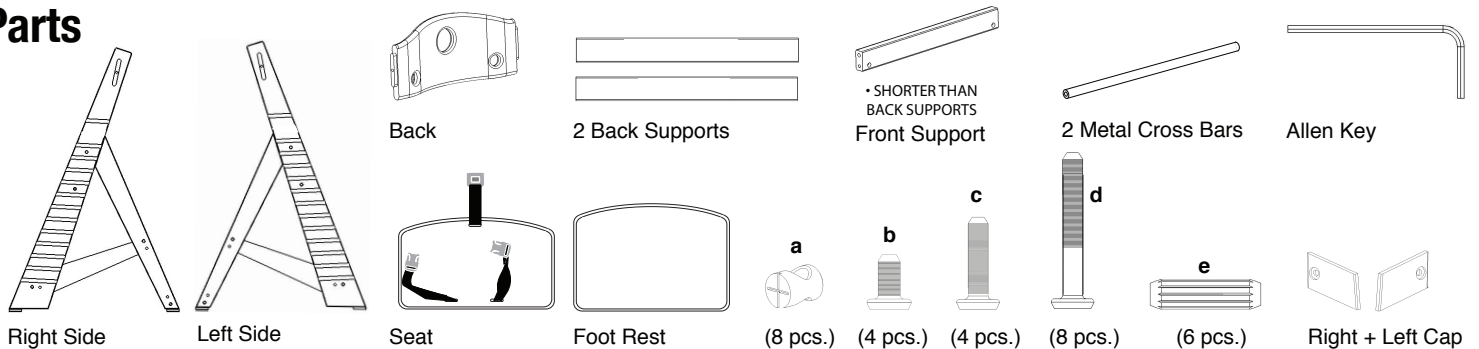

1

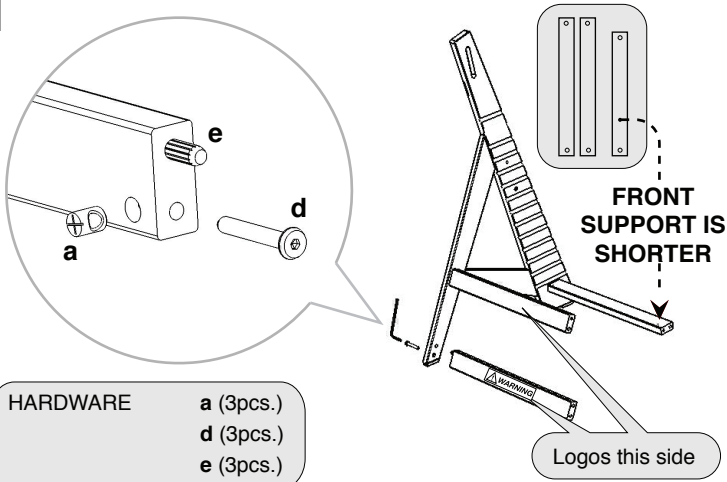

Insert a Wooden Dowel (e) into the larger hole in each of the Back Supports and Front Support. Insert a Wood Nut (a), as shown into the inner holes of the 3 Supports. Attach the 3 Wooden Supports as shown and insert Long Screws (d). Loosely tighten the Long Screws into Wood Nuts through the Left Side with the Allen Key. Labeling on the Rear Supports should be visible.

2

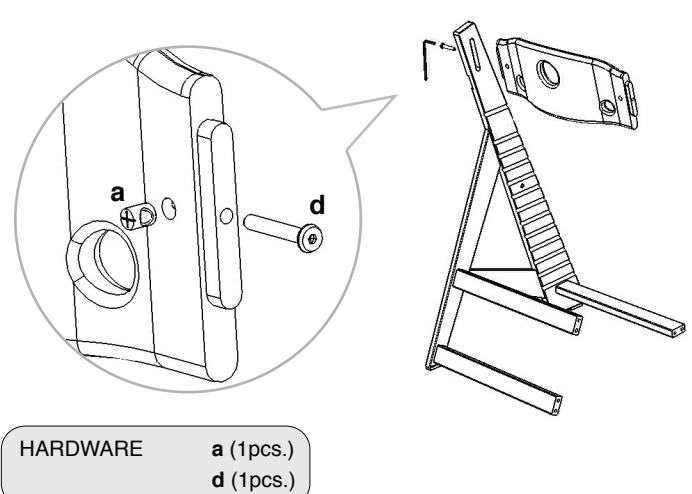

Insert a Wood Nut (a), as shown into the inner holes of the Back. Attach the Back as shown and insert a Long Screw (d). Loosely tighten the Long Screw into Wood Nut through the Left Side with the Allen Key.

3

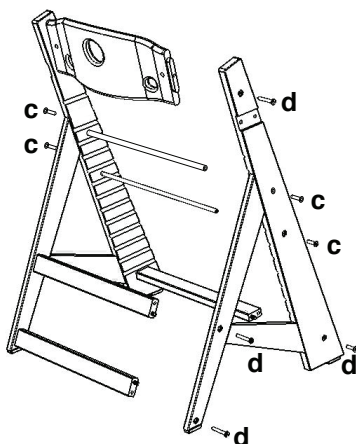

a.

**HARDWARE**  
a (4pcs.)  
d (4pcs.)  
e (3pcs.)

Insert the rest of the Dowels, Wood Nuts, and Screws as needed to attach the Right Side of the chair.

**DO NOT FULLY TIGHTEN SCREWS.**

b.

**HARDWARE**  
c (4pcs.)

Attach the 2 Metal Cross Bars as shown and insert Screws (c). Loosely tighten the Screws (c) into the Metal Cross Bars through Both sides with the Allen Key.

4

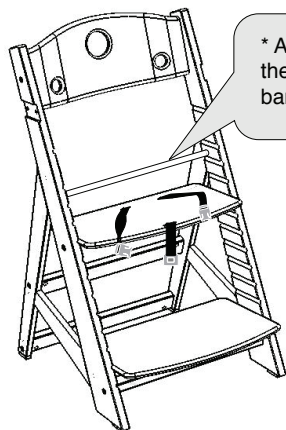

Slide in the Seat and Foot Plate with the curved edge facing forward. Make sure that the Seat and Foot Rest are at the appropriate height for the occupant. See the Seat and Foot Adjustment section for proper placement of the Seat and Foot Rest.

## 5 TIGHTEN ALL SCREWS (BOTH SIDES) IN ORDER 1-5 \_DO NOT OVER TIGHTEN!

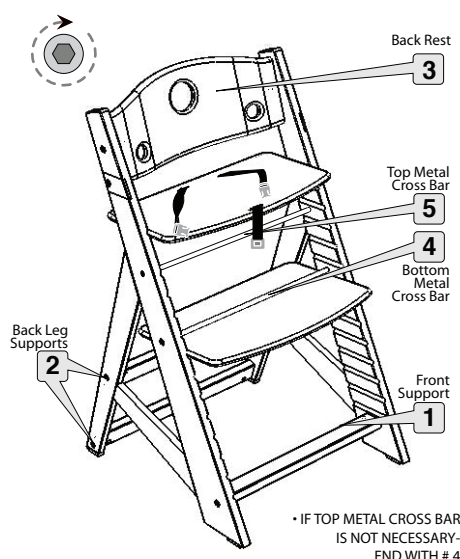

## 6 Caps

Attach Black Caps with 2 small Screws (b). as shown above. Repeat for Left.

**HARDWARE**  
b (4pcs.)

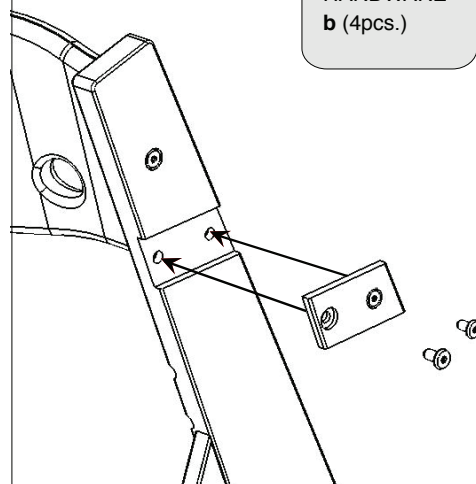

## Seat and Foot Adjustment

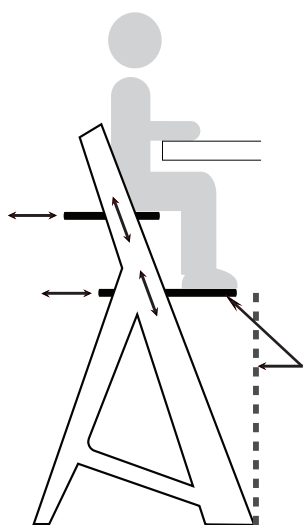

### Height

The seat is placed at optimal height when the child's elbows are level with the top of the table.

The foot plate is placed at optimal height when the child's foot can rest flat on its surface.

### Depth

For optimal depth of the seat, position child's back against backrest with seat supporting 3/4 of thigh.

For safety, the footrest should not exceed the front legs of the chair.

### Teen / Adult Use

Remove Seat Plate & Top metal cross bar.

Use the Foot Rest as the Seat Plate for a larger seating surface.

**TIGHTEN ALL SCREWS.**

## 3 Point Belt Operation

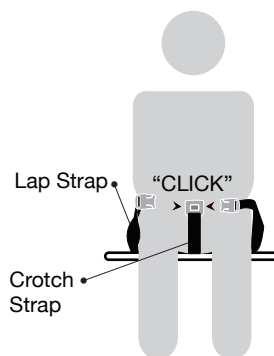

- Place child in seat. Crotch strap comes up between child's legs. Both Lap Straps come around child from the back and "CLICK" into Crotch Strap. Adjust length of Lap straps to secure child in seat.
- Press center button on Crotch Strap buckle to release child from belt.

### 5 Year Limited Warranty

Bergeron by Design warrants to the original retail purchaser of the Height Right Chair product, that if any part or component proves defective in material or workmanship within five years of the purchase date, the defective part will be repaired or replaced (at Bergeron by Design's discretion) free of charge. Warranty service may be performed by an authorized service center or at Bergeron by Design's discretion.

This warranty does not cover normal wear and tear, or damage caused by accident or misuse.

To exercise this limited warranty, the user should first obtain a Return Authorization Number from Bergeron By Design. The product must be delivered charges pre-paid (UPS recommended) to the factory or to an authorized service center, together with a copy of the original invoice, the Return Authorization Number and a written description of the problem.

### Customer Service

Toll Free: 1.866.529.8407  
International: 1.315.429.8407  
Fax: 1.315.429.8862

### Product Care

Clean chair with damp cloth; then wipe dry. With normal use, over time screws may loosen. Please maintain tight screws.

**Use chair on smooth level surface.**

**Height Right Chair**  
Color: Natural  
Model #  
61000000

### Notice

Use only Height Right Chair accessories and parts. Height Right Chair parts are not interchangeable with other manufacturers' products. Replace any worn parts immediately for safety. © 2013 Bergeron By Design.

# HEIGHT RIGHT<sup>TM</sup> chair

Revision 0313  
UMEPP03-13LIT

AGES 3 YEARS AND UP

5 EN PARTS

6 EN CHAIR + Early Pelvic Positioner + TRAY

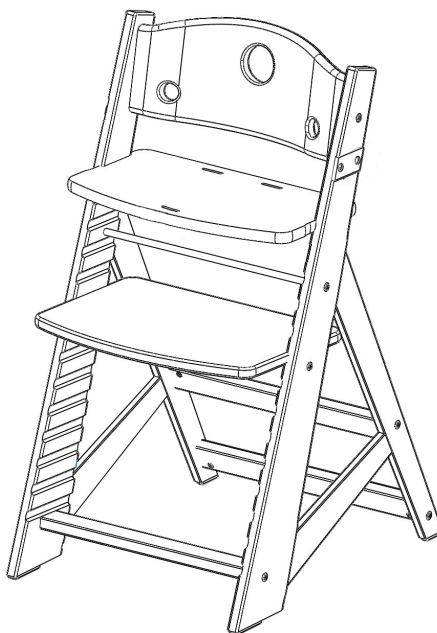

## CONVERSION TO

# HEIGHT RIGHT<sup>TM</sup> chair + Early Pelvic Positioner + Tray



FOR CHILDREN UNDER 3 YEARS OF AGE. ABLE TO SIT INDEPENDENTLY



## Height Right™ Chair + Early Pelvic Positioner + Tray

**⚠ WARNING:** For children under 3 years of age able to sit independently. NEVER Use the Tray without the use of the Early Pelvic Positioner (Early Pelvic Positioner and Tray sold separately)

**⚠ WARNING:** Prevent serious injury or death from falls or sliding out.

**⚠ WARNING:** The child should be secured in the chair at all times by the restraining system. The tray is not designed to hold the child in the chair. It is recommended that the chair be used only by children capable of sitting upright unassisted. The Early Pelvic Positioner is ALWAYS required when using the Tray for children under 3 years of age.

### ⚠ WARNING:

- Always secure child in the restraint
- Never leave child unattended
- Always keep child in view
- Secure straps tightly
- Never use as a stepping stool
- The front edge of the footrest should never extend beyond the bottom edge of the front supports at floor level
- Always use chair on smooth level surface

## Height Right™ Chair + Early Pelvic Positioner + Tray

### Parts

#### OPTIONAL Early Pelvic Positioner

- 2 long straps (pre installed)
- 1 short strap

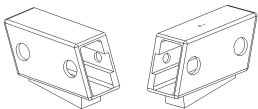

Right + Left Tray Clips

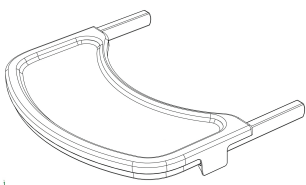

\* OPTIONAL TRAY WITH COVER

#### HEIGHT RIGHT CHAIR

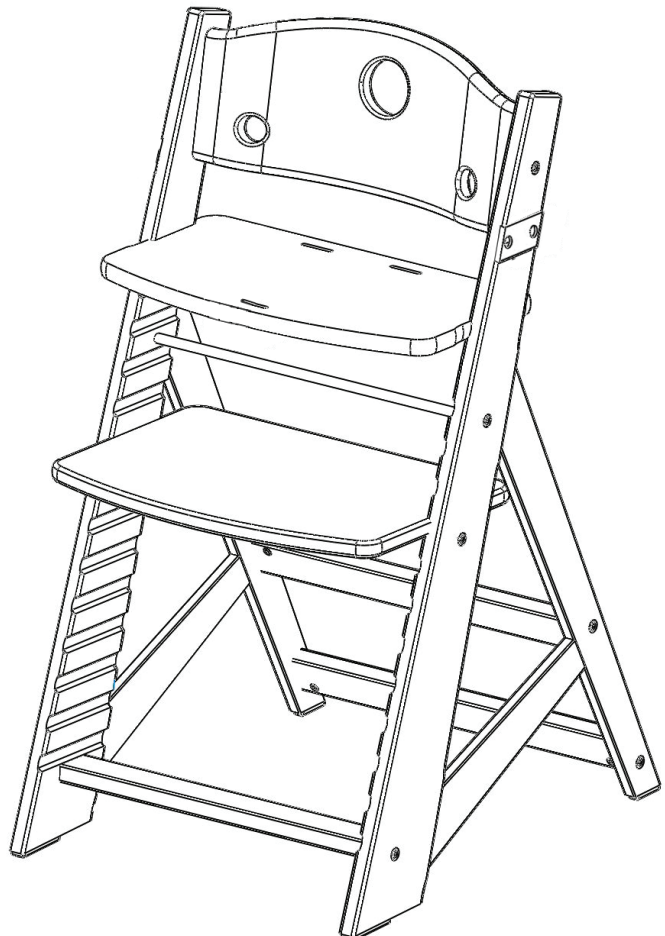

# Height Right™ Chair + Early Pelvic Positioner + Tray

## CHAIR CONVERSION

Early Pelvic Positioner + Tray Installation

**1** Loosen Screws

**2** Remove seat plate

**3** Using Allen key, Remove top metal cross bar

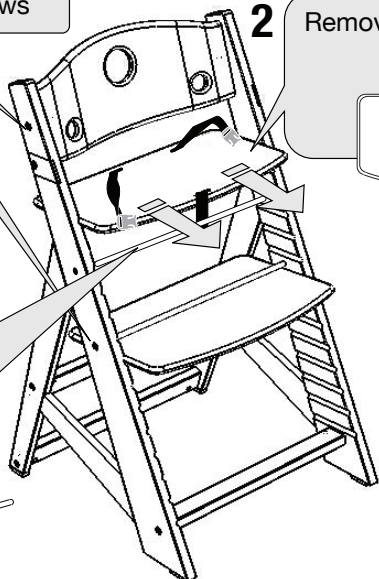

**4** Place seat plate flat on table.

Thread restraint straps up through Early Pelvic Positioner

REFERENCE PAGE 3 FOR CHILD RESTRAINT OPERATION

**4** Fasten Clips

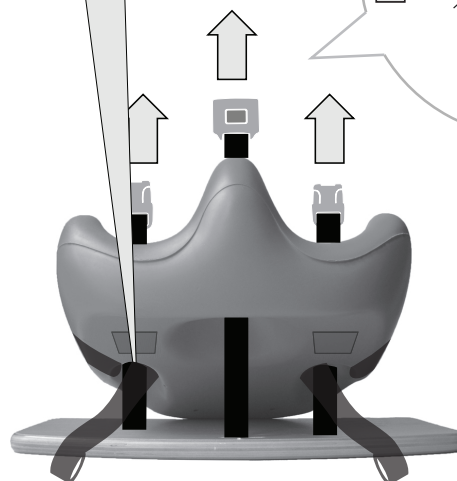

**5** Center Early Pelvic Positioner on Seat Plate.

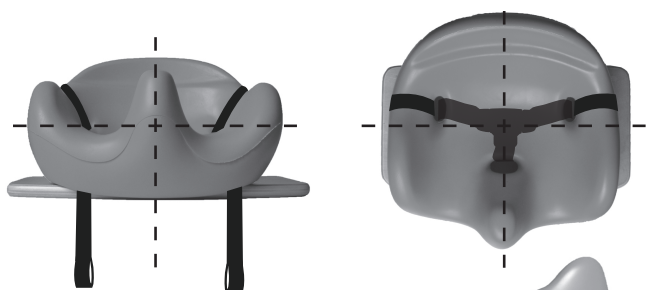

Front lip of Insert will overhang and mate to front edge of seat plate.

**6** Keeping the Early Pelvic Positioner centered on the seat plate, lift front edge of insert.

**7** Peel off paper to expose adhesive.

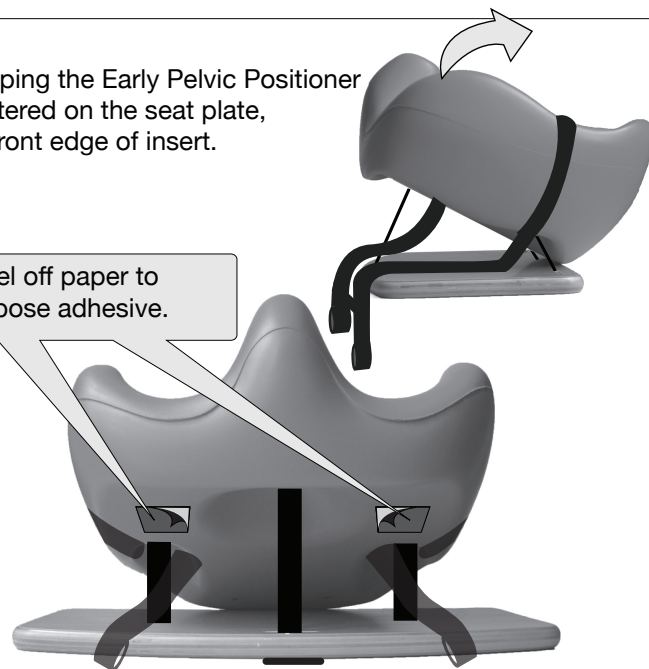

**8** Lower front edge back onto seat plate. Adhesive patches will contact wooden seat plate. Do not reposition the cushion for 24 hours to allow adhesive to bond.

Install Small loop strap by sliding long straps through the Smaller loop strap openings.

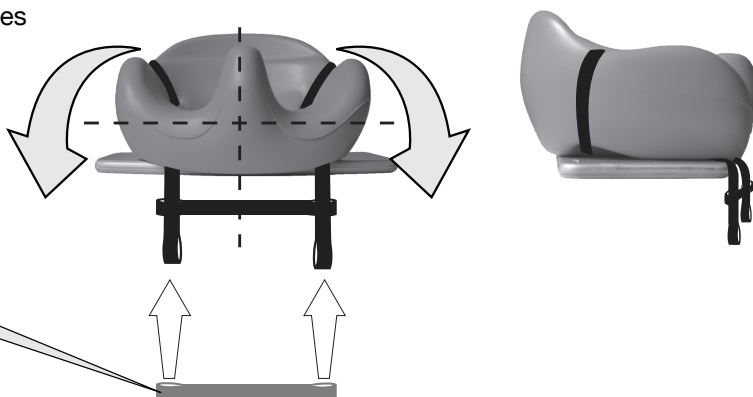

- 9** From the rear of the chair : Slide seat plate and Early Pelvic Positioner in 1ST rung above top metal cross bar until Early Pelvic Positioner mates with backrest.

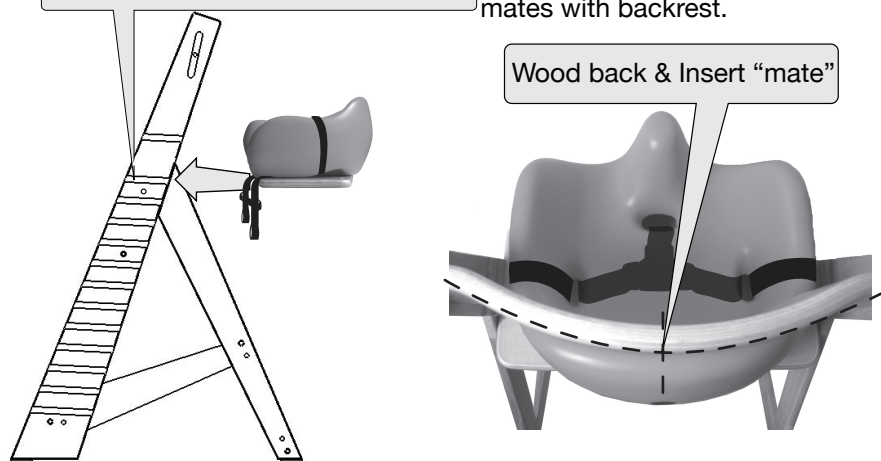

- 10** Thread top metal cross bar through hanging loops under Early Pelvic Positioner seat.



- 11** Reinstall top metal cross bar using original screws.



- 12** Install Tray Clips

Attach the Right Tray Clip as shown with 2 Supplied Screws. Repeat for Left.

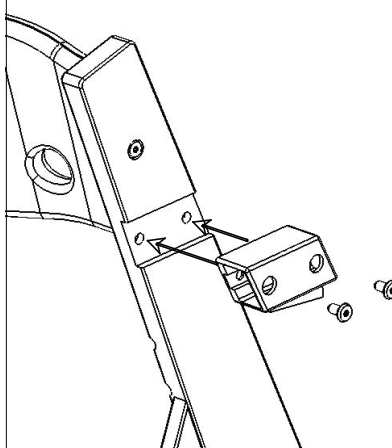

- 13** Installing Tray and using Clips

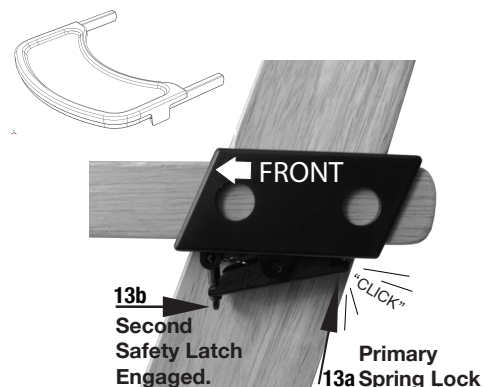

- a** When Tray is properly installed an audible "click" will be heard from primary lock.  
**b** Engage the second safety Latch Lever by pushing it forward into the primary spring lock.

- 14** TIGHTEN ALL SCREWS (BOTH SIDES) IN ORDER 1-5 \_DO NOT OVER TIGHTEN!

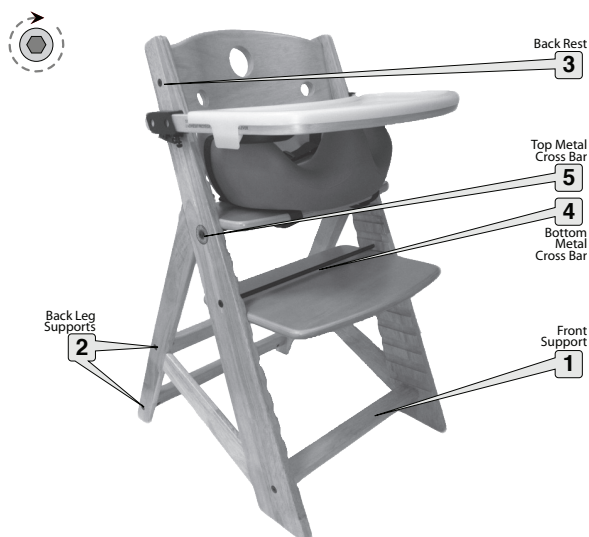

#### 5 Year Limited Warranty

Bergeron by Design warrants to the original retail purchaser of the Height Right Chair product, that if any part or component proves defective in material or workmanship within five years of the purchase date, the defective part will be repaired or replaced (at Bergeron by Design's discretion) free of charge. Warranty service may be performed by an authorized service center or at Bergeron by Design's discretion.

This warranty does not cover normal wear and tear, or damage caused by accident or misuse.

To exercise this limited warranty, the user should first obtain a Return Authorization Number from Bergeron By Design.

The product must be delivered charges pre-paid (UPS recommended) to the factory or to an authorized service center, together with a copy of the original invoice, the Return Authorization Number and a written description of the problem.

#### Customer Service

Toll Free: 1.866.529.8407  
 International: 1.315.429.8407  
 Fax: 1.315.429.8862

#### Product Care

Clean chair with damp cloth. With normal use, over time screws may loosen. Please check regularly. **Only use chair on smooth level surface.**

#### Notice

Use only Height Right Chair accessories and parts. Height Right Chair parts are not interchangeable with other manufacturers' products. Replace any worn parts immediately for safety. © 2013 Bergeron By Design.